

ECLISSE Syntesis® EI30 Battente

TELAIO CON PORTA TAGLIAFUOCO BATTENTE FILOMURO

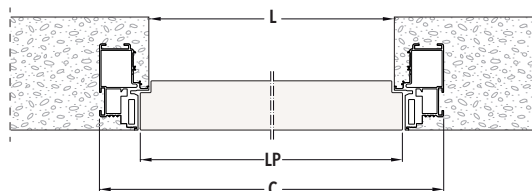

TELAIO IN ALLUMINIO | Solo anta singola

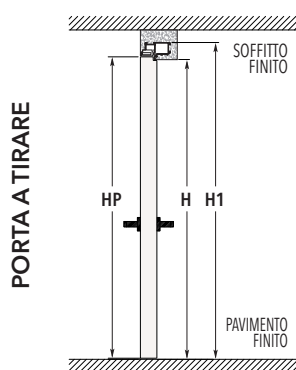
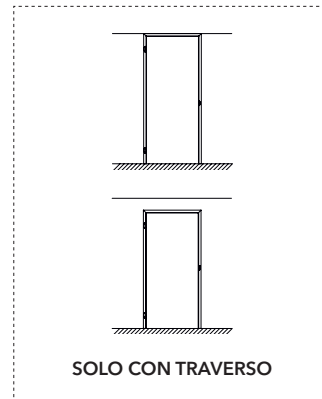
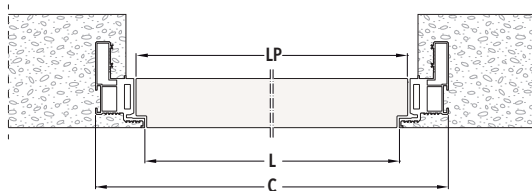
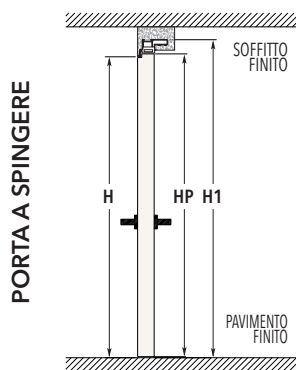

VARIANTE:
Disponibile anche con predisposizione per l'incontro elettrico.

LEGENDA			
L	Luca passaggio in larghezza	H1	Massimo ingombro in altezza
H	Luca passaggio in altezza	LP	Larghezza pannello porta
C	Massimo ingombro in larghezza	HP	Altezza pannello porta

Misure espresse in mm

CON TRAVERSO		
LxH	CxH1	LPxHP
600 x 2100/2400	700 x 2150/2450	616 x 2104/2404
650 x 2100/2400	750 x 2150/2450	666 x 2104/2404
700 x 2100/2400	800 x 2150/2450	716 x 2104/2404
750 x 2100/2400	850 x 2150/2450	766 x 2104/2404
800 x 2100/2400	900 x 2150/2450	816 x 2104/2404
850 x 2100/2400	950 x 2150/2450	866 x 2104/2404
900 x 2100/2400	1000 x 2150/2450	916 x 2104/2404
950 x 2100/2400	1050 x 2150/2450	966 x 2104/2404
1000 x 2100/2400	1100 x 2150/2450	1016 x 2104/2404

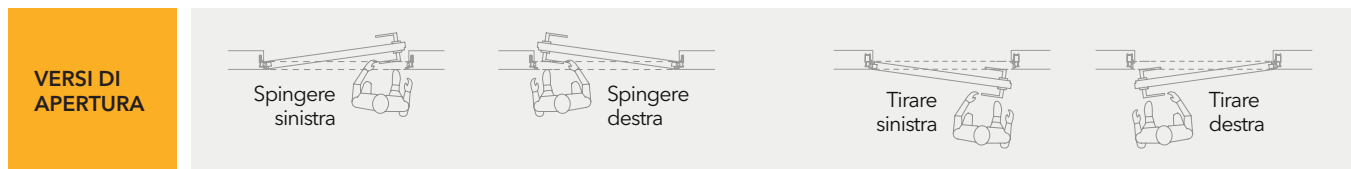

NOTE

Realizzazioni con intervalli ogni 50 mm in L e 50 mm in H

Disponibile solo con traverso

Specificare la richiesta per la predisposizione del chiudiporta DORMA ITS96 EN2-4; il telaio arriva predisposto per due cerniere Tectus

Ferramenta non compresa

Nella versione a spingere la luce di passaggio effettiva è ridotta dallo spessore del pannello porta

APPLICAZIONI

SU PARETE PER INTONACO

PORTA A SPINGERE

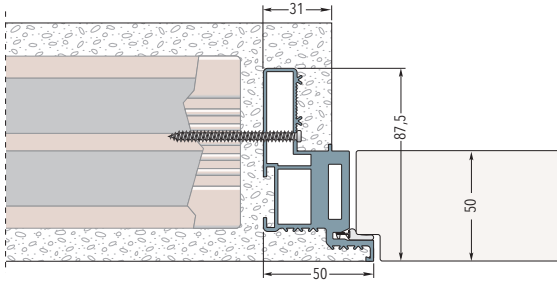

PORTA A TIRARE

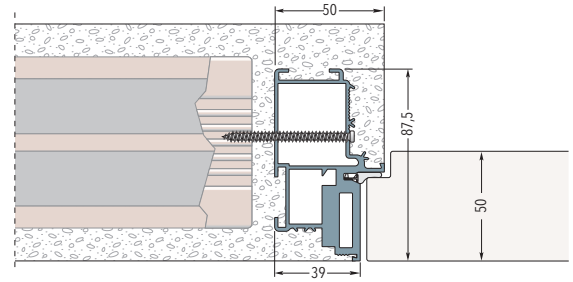

SU PARETE PER CARTONGESSO

PORTA A SPINGERE

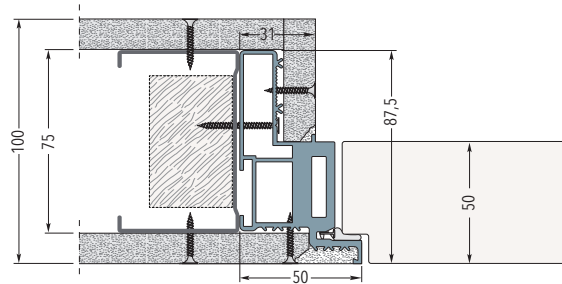

Lastra singola: Parete Finita 100 mm

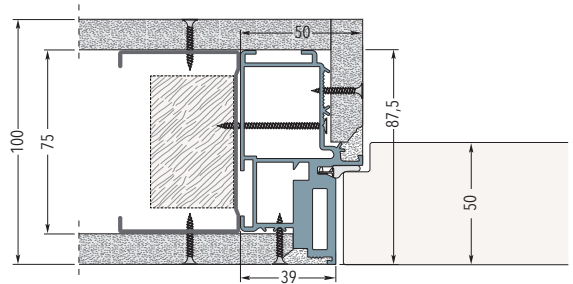

Lastra doppia: Parete Finita 100 mm

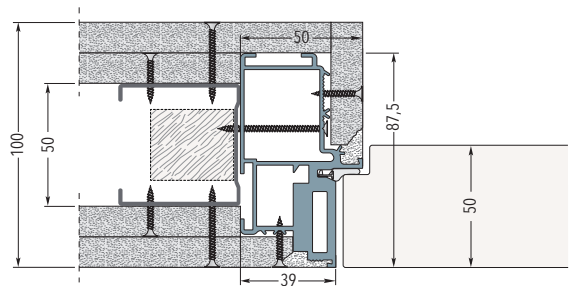
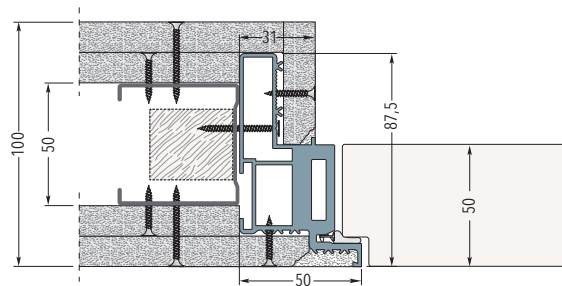

Lastra doppia: Parete Finita 125/150 mm

